

DIFFERENZIAL PRESSURE GAUGES WITH BOURDON TUBE



Diameter 100 and 160 with measuring system Cu-alloy with measuring system CrNi-steel

The pressure gauges are suitable for measuring of liquid and gaseous media, although this shouldn't be too viscous or be susceptible to crystallization. For aggressive media, which attack the copper resp. the copper alloy, other versions (5631, 5636) with stainless steel medium wetted parts are available. Both pointers turn around the same axle and given + and - pressure separately. The pointer of the low-pressure side as the form of a dial.



The pointer indicating the reduced pressure, is formed as a dial. On this scale, the differential pressure can be up to 50% of the display area directly read.

| Type | 5630 | 5635 | 5632 | 5636 | Options |
|----------------------|--|--------|---------------------------|--------|--|
| Diameter | 100 | 160 | 100 | 160 | |
| Symbol |  | | | | with glycerine filling at BR 5630 and 5632 |
| Accuracy class | 1,6 acc. to EN 837-1 | | | | |
| Ranges ¹⁾ | 0...0,6 up to 0...1000 bar negative or positive / negative and positive overpressure | | | | MPa, kPa |
| Application | Constant load: up to the end of scale value Alternating load: 0,9 x end of scale value Short-time: 1,3 x overload capacity | | | | |
| Case | Steel, black varnished/ stainless steel (0...2,5 up to 0...25 bar) | | | | rear flange |
| Ring | Steel, black varnished | | | | front flange |
| Window | flat instrument glas | | | | multi-composite laminate safe |
| Dial | Al white, scale and printing black, dual scale bar/mWS | | | | |
| Pointer | Al red (knife edge pointer), Al schwarz, fixed to the turnable scale disc | | | | Marker pointer |
| Movement | CuZn-alloy, bearing parts German-Silver | | | | Stainless steel |
| Measuring element | Cu-alloy < 100bar bourdon tube ≥ 100 bar 1.4571 helical spring | | CrNi-steel 1.4571 | | |
| Pressure connection | CuZn-alloy | | CrNi-steel 1.4571 | | |
| Connection position | radial bottom, parallel (one behind the other) | | | | |
| Thread | 2 x G 1/2 B, 2 x M20x1,5 | | | | others on request |
| Temperatures | Medium: -20°C up to 60°C ²⁾ ambient: -20°C up to 60°C | | Medium: -20°C up to 100°C | | |
| Temperature drift | 0,3%/10K deviation of normal temperature 20°C | | | | |
| Protection | IP54 acc. to EN 60529/IEC 529 | | | | with glycerine filling IP65 |
| Orifice | | | | | Ø 0,4; Ø 0,8 |
| Approx. Weight | 1,0 kg | 1,6 kg | 1,0 kg | 1,6 kg | |

Dimensioned drawing

Dimensions in mm

| Type | in stock 0 ... 2,5 bis 0 ... 25 bar | | | | | | | | | | |
|------|-------------------------------------|-------|---------|-------|-------|---------|-------|----|---|----|----|
| | NG | D+/-1 | a+/-0,5 | b+/-1 | k+/-1 | G | h+/-1 | SW | c | c1 | c2 |
| 5630 | 100 | 102 | 15,5 | 80 | 32 | G 1/2 B | 85 | 22 | 6 | 3 | 20 |

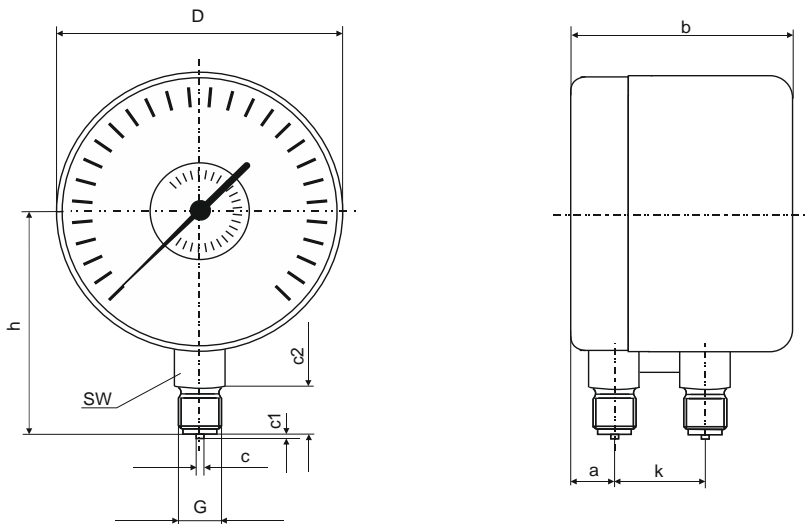

| Type | Manufacturing goods < 0 ... 2,5; > 0 ... 25 bar | | | | | | | | | | |
|-----------|---|-------|---------|-------|-------|---------|-------|----|---|----|----|
| | NG | D+/-1 | a+/-0,5 | b+/-1 | k+/-1 | G | h+/-1 | SW | c | c1 | c2 |
| 5630/5632 | 100 | 100 | 15 | 85 | 32 | G 1/2 B | 87 | 22 | 6 | 3 | 20 |
| 5635/5636 | 160 | 160 | 33 | 104 | 32 | G 1/2 B | 117 | 22 | 6 | 3 | 20 |

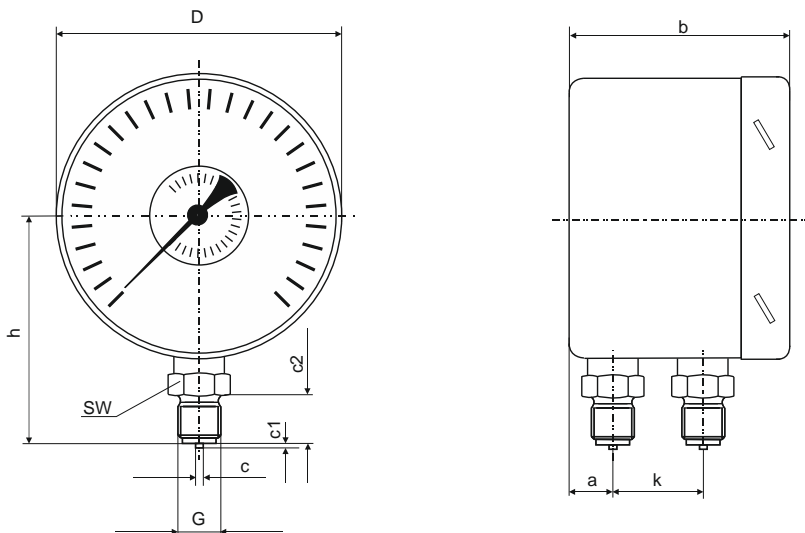

Explanations of page 1

1) The range must be selected in consideration of the highest static pressure applied!
 In heating circuits with circulating pumps the total pressure is calculated pressure given by the pumps plus the water column above. The pressure differential to be indicated should be no less than 1/8 of the full scale range.

When ordering please state both: a) static pressure applied b) differential pressure to be indicated

2) max. temperature +100°C brazed